

DISPENSER AQUAPHOR RO PRO 100 OPERATIONAL MANUAL

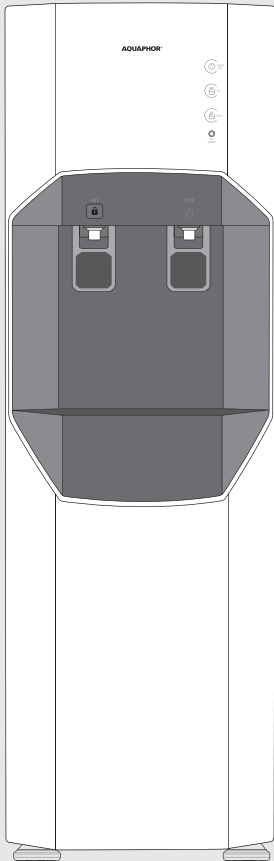

◆ Product Safety

- Precautions 2-5

◆ General Product Information

- Part name 6
- Water purifier structure 7
- Filtration system 8
- Features 9
- How to use cold&hot water purifier ... 10
- ECO / UV System 11
- Filter replacement method 12-13
- Troubleshooting common problems .. 14-15
- Cleaning cycle&method 16
- Product installation17-18
- Product specification 19
- Product warranty 20

Please read this manual for proper and safety.
Safe-keep this manual as it contains the product warranty.

Please read all precautions carefully to prevent any potential dangers and/or damages.

Precautions are divided into three types depending on the degree of potential danger/damage.

⚠ Danger: If not observed, serious injury, bodily harm and/or even death may occur.

⚠ Warning: If not observed, serious injury, bodily harm and/or property damage may occur.

⚠ Caution: If not observed, slight injury, minor bodily harm and/or property damage may occur.

⚠ This symbol is used to notify the dangers caused by improper use.
Water purifier should be maintained periodically. Manufacturer/distributor is not responsible for any damages caused by improper maintenance by any individuals and/or third parties.

PRECAUTIONS

Precautions for power supply

Danger ⚠ Plug power cord into 120V outlet only.

※ Failure to do so can cause fire and/or electric shock.

Danger ⚠ Clean plug before use, by wiping off any dust and/or foreign particles.

※ Failure to do so can cause fire and/or electric shock.

Danger ⚠ DO NOT use plug if it is damaged and/or if the wires are exposed from the cord.

※ Failure to do so can cause fire and/or electric shock and may also result in water leakage.
※ Please contact your local customer service for repair and replacement.

Danger ⚠ Unplug power cord before replacing filters.

※ Failure to do so can cause fire and/or electric shock.

Danger ⚠ DO NOT bend, tie or pull power plug by its cord.

※ Failure to do so can cause fire and/or electric shock.

Danger ⚠ The outlet should be rated greater than 10A. Use separate outlet for this product.

※ Overloading outlet with too many plugs may cause fire and/or electric shock.

Danger ⚠ DO NOT modify or disassemble plug.

※ Failure to do so can cause fire and/or shock.

Danger ⚠ DO NOT plug and unplug the power cord with wet hands.

※ Failure to do so can cause fire and/or electric shock.

Precautions for installation

Danger ⚠ DO NOT install this product in moist or wet environment, such as bathrooms, shower rooms and/or outdoors.

※ Failure to do so can cause fire and/or electric shock.



Danger ⚠ DO NOT bend or twist the inlet hose.

※ Failure to do so can cause electric shock from water leakage.

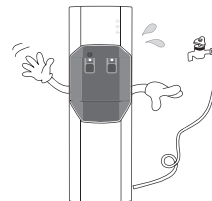

PRECAUTIONS for installation

Precautions for installation

Caution DO NOT install this product under direct sunlight and avoid high heat areas.

※ Failure to do so can cause deformation of the product exterior.

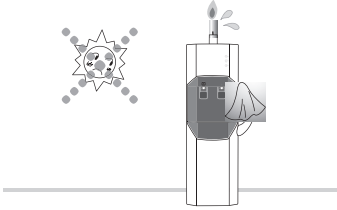

Caution Place the product on a level and hard surface floor.

※ Failure to do so can cause malfunction.

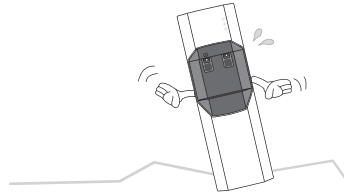

Caution Connect the product to cold water.

※ Failure to do so can cause damage to filters and/or result in poor performance.

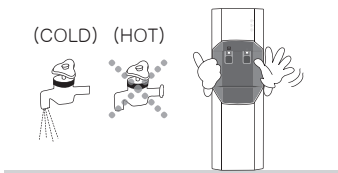

Caution Product must be at least 8 inches away from the wall to allow for proper ventilation.

※ Failure to do so can cause overheating and malfunction.

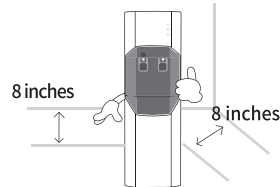

Precautions for use

Danger DO NOT apply unnecessary force when using the product.

※ Failure to do so can cause malfunction, damage and/or electric shock.

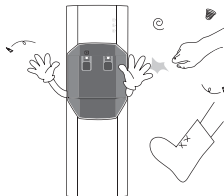

Caution DO NOT attempt to repair, disassemble or modify product.

※ Failure to do so can cause fire and/or electric shock.

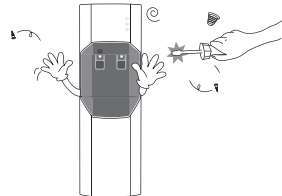

PRECAUTIONS for use

Precautions for use

Danger DO NOT insert sharp wires and/or screwdrivers into the product.

※ Failure to do so can cause malfunction and/or electric shock.

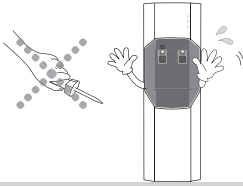

Caution DO NOT touch hot water and be careful when handling hot water

※ Failure to do so can cause severe burns and body harm.

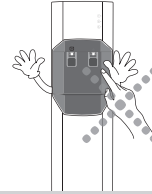

Caution DO NOT tilt the product more than 45 degrees while transporting product.

※ Failure to do so can cause malfunction.

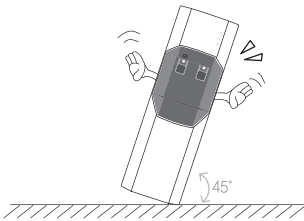

Caution DO NOT move the product while it is in operation connected to water and power supply.

※ Failure to do so can cause malfunction.

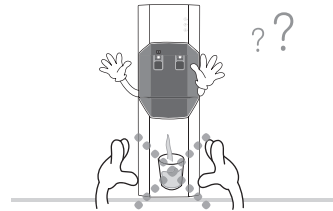

Precautions for installation

Caution DO NOT place heavy objects on top of the product.

※ Failure to do so can cause damage the product.

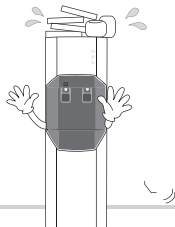

Caution DO NOT turn power on when water supply is cut off.

※ Failure to do so can cause damage the product.

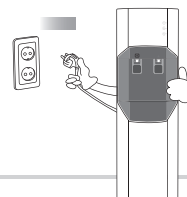



PRECAUTIONS for use

Precautions for use

Caution  DO NOT use Benzene or gasoline when cleaning the product.

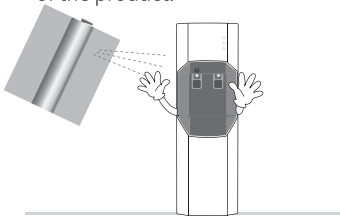
※ Failure to do so can cause discoloring, peeling and/or damage to the exterior of the product.



Danger  UNPLUG power and SHUT OFF water supply to the product when not in use over an extended period of time.

※ Failure to do so can cause fire and/or water leakage.

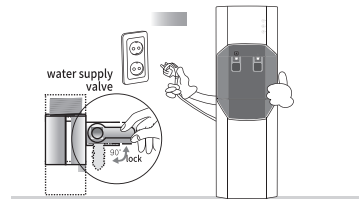

※ This appliance is not intended for use by person (including children) with reduced physical, sensory or mental capabilities, or lack of experience and knowledge unless they have been given supervision or instruction concerning use of the appliance by a person responsible for their safety.

※ Children should be supervised to ensure that they do not play with the appliance.

Caution  When discarding parts/filters and/or disposing of the product entirely, please adhere to local guidelines.
※ Failure to do so can cause environmental pollution.

Caution  When installing the product, always use genuine parts.
※ Failure to do so can cause water leakage and product damage.

Caution  DO NOT install the product in severe and extreme temperatures.
※ Failure to do so can cause overheating or freezing.

PART NAME

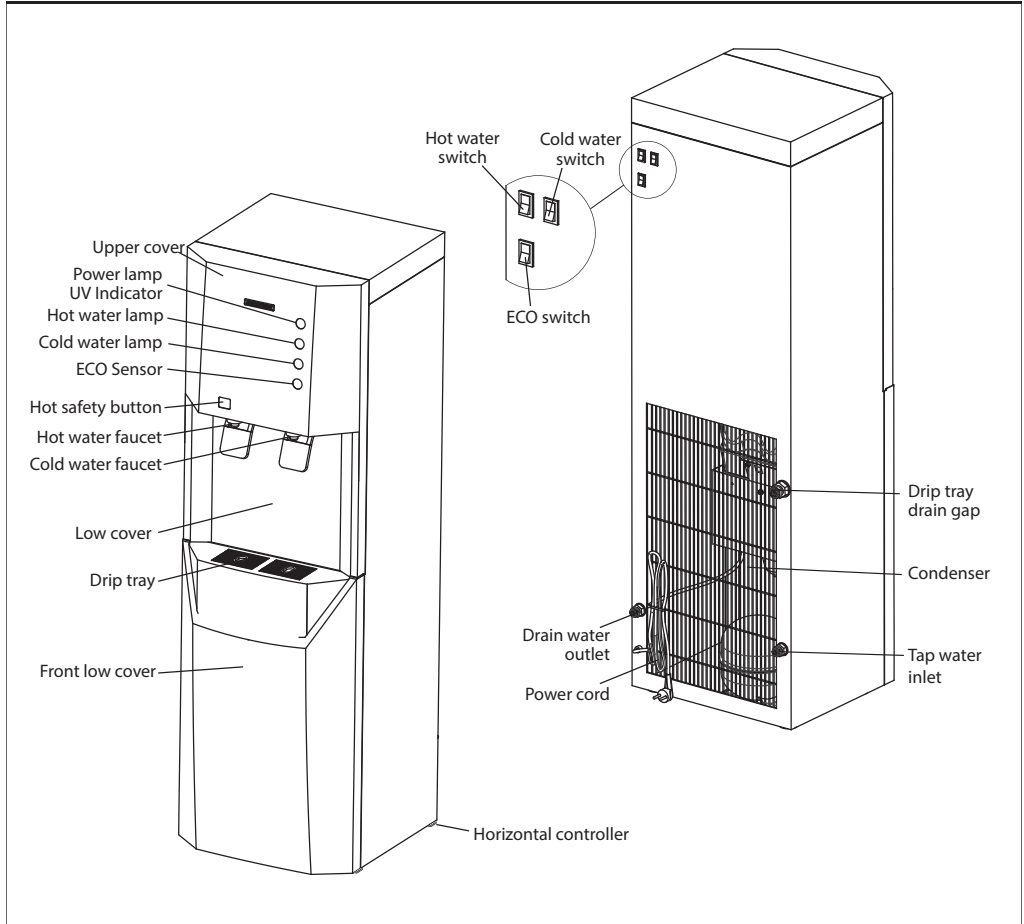

WATER PURIFIER STRUCTURE

Interior diagram

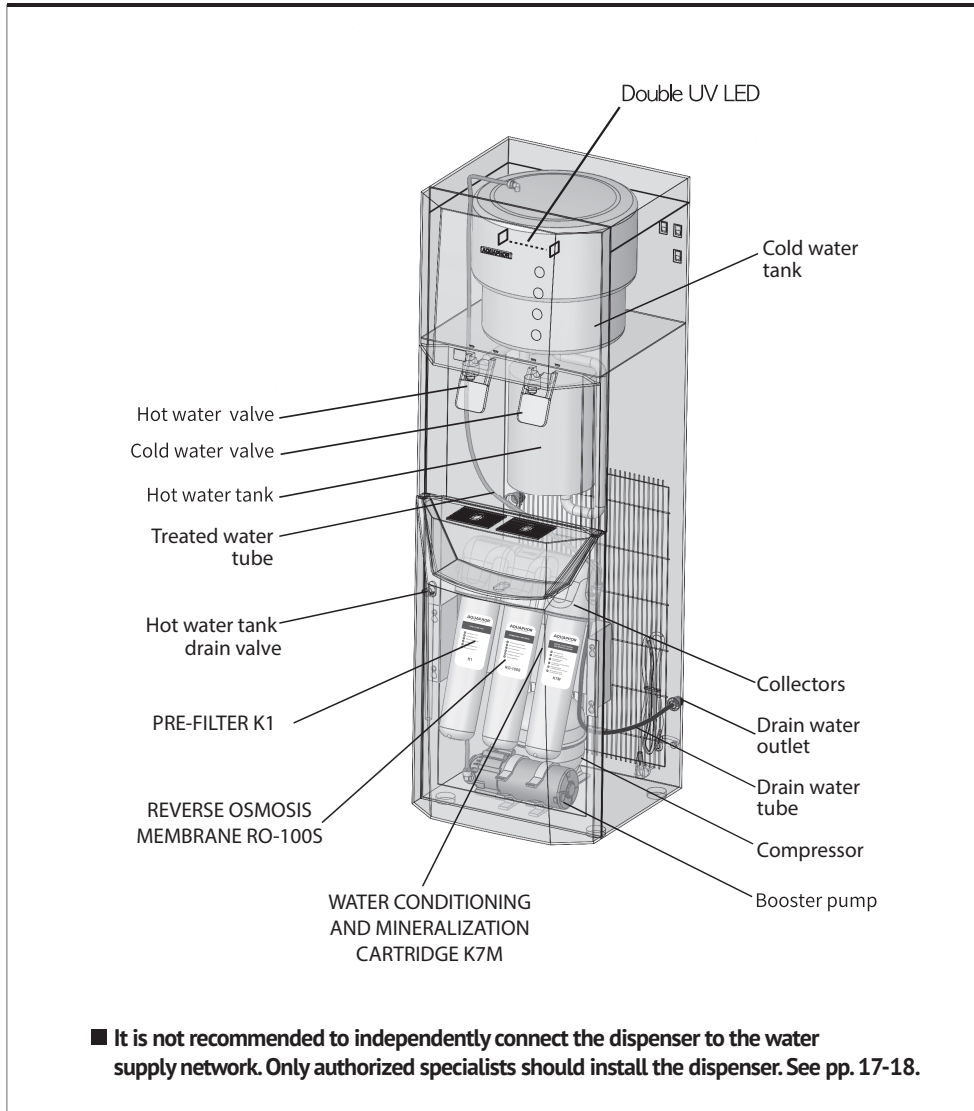

FILTRATION SYSTEM

Filtration system

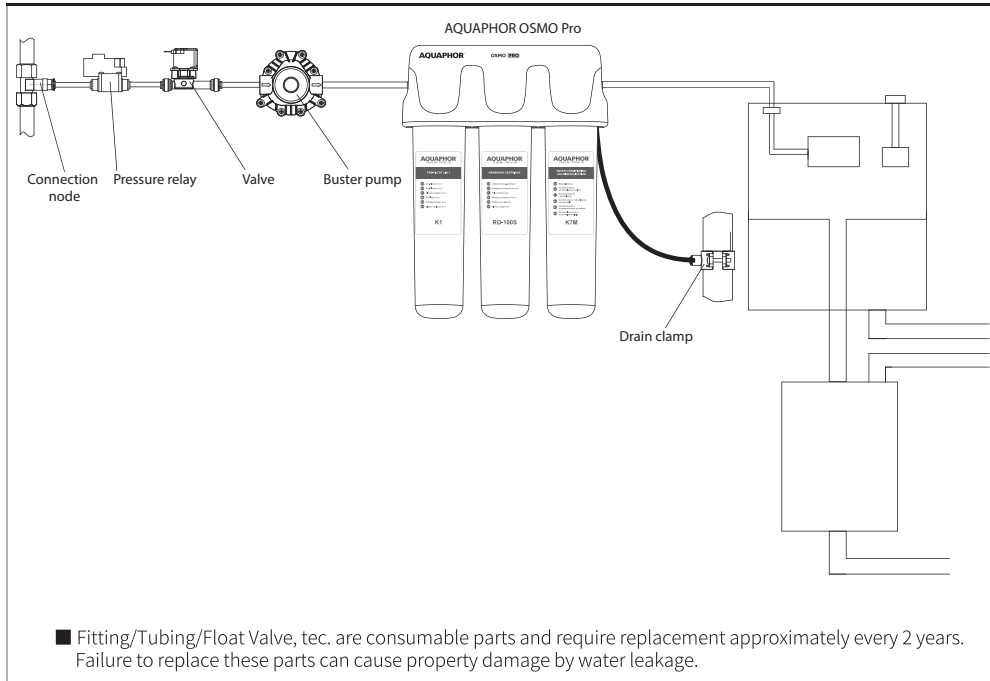

Filter replacement cycle

	1st stage	2nd stage	3rd stage
Filter	K1	RO-100S	K7M
Function	PRE-FILTER 2 in 1 Cascade filtration method, combines mechanical and sorption cleaning in one cartridge. Increased AQUALEN™ fiber content for increased dirt holding and iron removal. Reduces suspended and sediment particles matter 3 microns and larger.	REVERSE OSMOSIS MEMBRANE CARTRIDGE The reverse osmosis membrane unit removes organic and inorganic compounds and salts from water as well as softens it.	WATER CONDITIONING AND MINERALIZATION Enriches water with useful minerals that improve taste and correct drinking water salt balance.
Service life (operating time)	Up to 6 months	1.5–2 years	Up to 12 months

FEATURES

- ◆ **R/O membrane filtration system**

3 stages filtration system with R/O membrane filter provides fresh and clean water.

- ◆ **Direct water supply from the water supply facilities.**

Easily get purified water with low price.

- ◆ **High performance purification system.**

Water pretreatment (removal of contaminants and residual chlorine) ► Reverse osmosis membrane (removal of organic and inorganic compounds) ► Microfiltration mineralizing cartridge (removal of general bacteria and remaining mineral water).

- ◆ **Safety of hot water tank**

Anti-overheating function(manual bi-metal reset) & automatic temperature control function (automatic bi-metal reset) provides safety from hot water overheating.

- ◆ **Water level control**

Automatic water level control function protects filter life and product operation long term.

- ◆ **Fresh water**

Enjoy +4...+12 °C of cold water and +70...+90 °C of hot water any time you want.
The best fresh water as it blocks dust and bacterial contamination.

- ◆ **Classy design**

Modern, classy and elegant design fits everywhere and stands out.

- ◆ **Power-saving features**

If you use only cold water, please turn off the hot water switch.
It reduces the electric cost of household.

- ◆ **Economic / practical advantages**

Easy to install and use.

HOW TO USE HOT&COLD WATER PURIFIER

1. Plug the power cord to outlet.

※ Please verify voltage compatibility before plugging in.

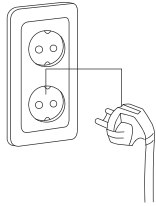

2. Open the water supply valve

※ Product will not purify water, if the water supply valve is closed.

(Please Not: The water supply valve should only be closed if the product is not going to be used for an extended period of time. Otherwise, it would remain open at all times.)

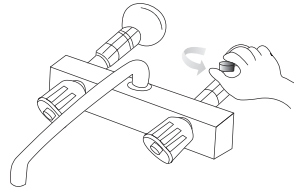

3. How to save the hot water

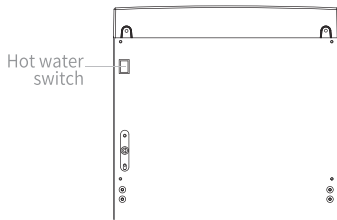

Please turn on the hot water switch

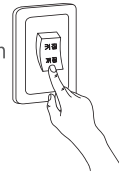

Please turn off the hot water switch when not using the hot water.

4. How to drink the purified water

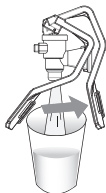

Cold water faucet

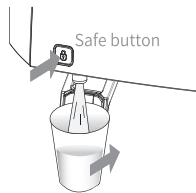

Hot water faucet



Caution

After confirming the water in the hot water tank, please turn on the hot water switch. (Failure to do so can cause product damage.)

ECO / UV SYSTEM

HOT&COLD + UV STERILIZER FUNCTION

- ECO function helps to reduce power consumption by automatically turning off the heating functions when no light surrounding the product is detected by the illuminance sensor.
- When brightness is detected by the illuminance sensor, ECO function is terminated to automatically begin heating again.
- How to operate ECO Function (Illuminance Sensor)?
 - ① Turn on the ECO switch at the back of the product.
 - ② The HOT water lamp will turn Amber.
 - ③ When activated, the HOT water lamp will turn green.
 - ECO SW ON (Day) -HOT water lamp : Amber
 - ECO SW ON (Night) -HOT water lamp : Green

UV LED SYSTEM

- UV LED sterilization is operated initially when the electronic power cord is plugged. There is no on/off S/W for UV LED operation and it is operated automatically. The function of UV LED could be deteriorated 5 years later after use. During operation of UV LED, the UV LED lamp flickers on and off.
- STERILIZATION CYCLE : 2 hours/1 day

※ Please make sure to unplug power cord when opening the tank lid.

- Failure to do so can cause a safety accident by the light of UV LED in the cold tank.

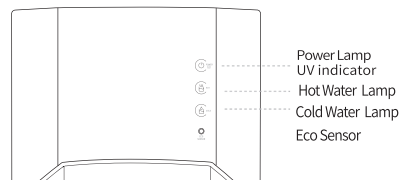

FILTER REPLACEMENT METHOD

1. Please shut off the Water Supply and unplug the power cord, prior to replacing new filters.

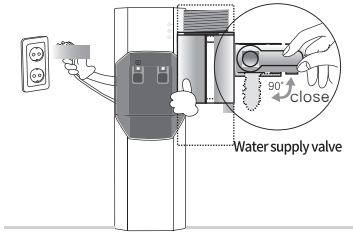

2. Remove the drip tray.

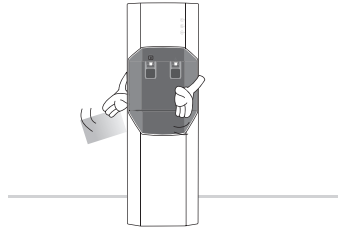

3. Push down on the lower panel and pull forward to remove it.

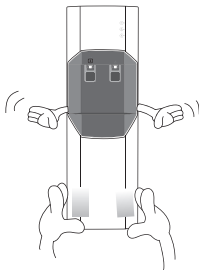

4. Please remove the old filters and insert the new filters in the same slots.

- To remove a filter turn the filter counter clockwise and remove it.
- Rinse the O-rings of the cartridge under a water stream.
- Remove the overwrapping film from the cartridges and transport plugs (if any) from the cartridges.
- The cartridges are inserted into the corresponding collectors until they stop and turned clockwise, until a click.

5. Once all the filters have been installed or replaced securely, please make sure to open the water supply valve and plug the power cord back into the outlet.

(Please clean the filters at least one time before using.)

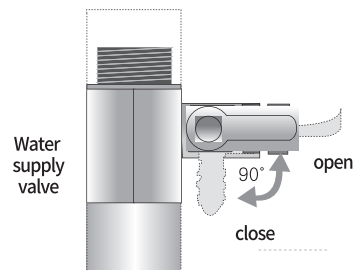

FILTER REPLACEMENT METHOD

■ Please shut off the water supply (close the water supply valve) and unplug the power cord, prior to replacing new filters.

- To remove a filter turn the filter counter clockwise and remove it.

Replacing filters K1 and K7M

- Remove the overwrapping film from the new K1, K7M filters.
- Remove transport plugs (if any) from the filters.
- Insert the new K1 and K7M filters into the corresponding collectors until they stop and turned clockwise, until a click.
- Remove the RO-100S filter and insert the service plug into the central slot.
- Please, open the Water supply valve.
- Please, open the Drain valve of the hot water tank. Drain the water within 10 minutes.
- Please, close the Drain valve of the hot water tank and Water supply valve.
- Remove the service plug from the slot of the reverse osmosis membrane unit and replace it with the membrane cartridge RO-100S.
- Please, open the Water supply valve.

Replacing RO-100S filter

- Please shut off the water supply (close the water supply valve) and unplug the power cord, prior to replacing new filters.
- To remove a filter turn the filter counter clockwise and remove it.
- Remove the overwrapping film from the new RO-100S filter, then insert the filter into the slot of the membrane filter until they stop and turned clockwise, until a click.
- Please, open the Water supply valve.
- Please, open the Drain valve of the hot water tank. Drain the water within 60 minutes
- Please, close the Drain valve of the hot water tank.



After replacing new filters make sure the dispenser connections are tight. Attention! If leaks are found, immediately turn the inlet cock of the connecting assembly to its closed position and check the connections. Turn the inlet cock of the connecting assembly to its open position again to continue the flushing procedure after the leak is repaired.



- Please make sure to change filters periodically based on the recommended exchange schedule.
- Untimely filter changes that exceed the recommended exchange schedule will significantly reduce filter performance and degrade the quality of water.
- Please note that the filter exchange schedule may vary depending on quality of the tap water supply.
- Always use genuine filters for filter replacement.
(Water quality and performance may be affected negatively when using non-genuine filters.)
- ※ It is strongly recommended that an authorized technician performs all filter exchange service.
Manufacturer/Distributor is not responsible for any service provided by an unauthorized third-party technician.
- The filter exchange schedule is recommended regardless of the water volume used.

TROUBLESHOOTING COMMON PROBLEMS

※ Please refer to the common troubleshooting solutions before contacting customer service center.

Problem	Cause	Solution
Insufficiently heated water	Low power supply	check voltage rate.
	Hot water switch off	Check to make sure that the hot water switch is turned on.
Insufficiently chilled water	Low power supply	Check voltage rate.
	Cold water switch off	Check to make sure that the cold water switch is turned on.
No water comes out	Filter Change Needed	Check filter exchange schedule and contact local customer service center.
	Water Supply Shut Off	Unplug the power cord and pluck back in to restart the system.
	Tubing Blockage	Check the tubing to make sure that it is not bent or kinked to prevent water flow.
No heating	Temperature Controller Shut Down/Heater Malfunction	Turn off the hot water switch and contact local customer. (Temp. Controller automatically shuts of power supply to hot water tank to prevent overheating.
Abnormal Hot & Cold Water Temperatures	Heavy Water Consumption	High volume of water consumption will cause the water temperatures to fluctuate. Please allow 5-10 minutes for the temperatures to recover.
Noisy Sound	Compressor Operating Sound	When the compressor is activated, it is normal to hear sounds of the refrigerant flowing through the system.

TROUBLESHOOTING COMMON PROBLEMS

※ Please refer to the common troubleshooting solutions before contacting customer service center.

Problem	Cause	Solution
Low Water Production	Filter Change Needed	Replace filters.
	Low Water Pressure	Depending on the water pressure of the environment, water production will vary.
Water Leakage	Poor Connection to Water Supply	Shut off Water Supply Valve and contact local customer service center immediately.
Unpleasant Water Taste/Odor	No use over 3 days	Clean the cold water tank.
	Poor Environment Conditions	Clean the hose of cold water and cold water tank.
Particle in the purified water	Bubbles when the water supply	If the bubbles from water is not settled down after 15 minutes, please contact the local customer center.

Disabling the filter dispenser for a long time

- Turn off the filter dispenser (heating and cooling switches on the rear panel), disconnect the device from the network.
- Wait until the hot water cools.
- Drain the remaining water from the hot water tank by opening drain valve of the hot water tank.
- Press the cold water lever to drain all the water from the cold water tank.

CLEANING CYCLE & METHOD

Hot Tank and Cold Tank Cleaning

1. Shut off the water supply valve and unplug the power cord.
2. Drain all water in the cold tank by dispensing it from the cold water nozzle.
3. Remove the lower panel and unscrew the hot water drain valve.
Drain the remaining water completely.
(Please be careful when draining out the hot water as it may cause severe burns.)

4. Unscrew the two screws on the left and right at the back of the product and remove the top cover.
Then remove the cold tank cover.

(Please be careful not to damage the rubber packing when removing the cold tank cover. Please use caution to prevent injury. The cold tank is made out of stainless steel.)

5. Clean the cold tank by flushing it out with water.
After washing with water, make sure to close the drain valve and then put the lid on the water tank.

6. Open water supply valve and check for any water leakage until the cold tank is completely full. Then, put the cold tank cover back on top of the tank.

7. Please monitor the product for a day for any leakage.
If there is any water leakage, please contact the local customer service center immediately.

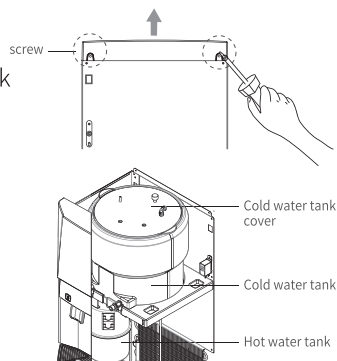

Cleaning Cycle

Cleaning	Cycle	method
Exterior	Once a week	Clean exterior with a non-abrasive soft cloth. (Never use Benzene, gasoline or thinner to clean the product.)
Drip Tray	Frequently	Clean the drip tray with a neutral detergent frequently.
Fitting Tubing	more than every 2 years	Check all fittings and tubings when change the filters. Replace fittings and tubings, if necessary.
Water intake Nozzle	Once a day	Unscrew the nozzle in a counterclockwise direction to separate it. Then thoroughly clean the nozzle openings with a sterilized swab. After cleaning, please screw the nozzle back on tightly.

PRODUCT INSTALLATION

Connecting assembly Installation

Please, follow the instructions in the Installation section to install your dispenser correctly.

ATTENTION! It is not recommended to independently connect the dispenser to the water supply network. Only authorized specialists should install the dispenser.

- Find a convenient location for your dispenser. Attention should be paid to prevent the supply tubes from bending and twisting.
- Turn water off at the mainline.
- Make sure that the gasket of the connecting assembly is installed.
- Install the connecting assembly in accordance with local regulations.
- Close the inlet cock of the connecting assembly and supply water from the cold water supply line to make sure that the connection is tight.
- Connect the corresponding JG tube.

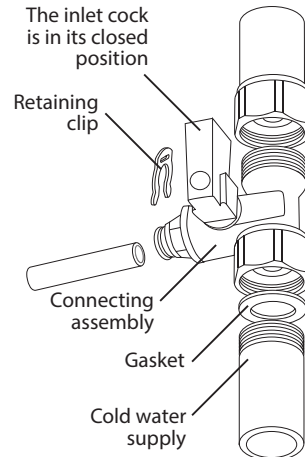

The end of the pipeline must be flat, where the connecting assembly is connected. Do not use excessive force when tightening the clamping nut. Otherwise, it will damage the gasket.

How to connect the JG tubes

Pull the retaining clip out from under the plastic sleeve, insert the pre-moistened end of the tube into the plastic sleeve until it stops about 15 mm deep and house the clip.

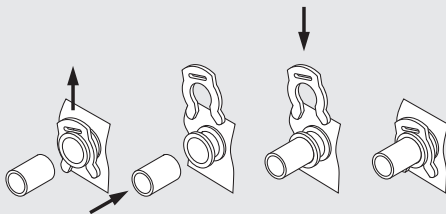

How to disconnect the JG tubes

Pull the retaining clip out from under the plastic sleeve and pull the tube out by pressing on the end of the plastic sleeve.

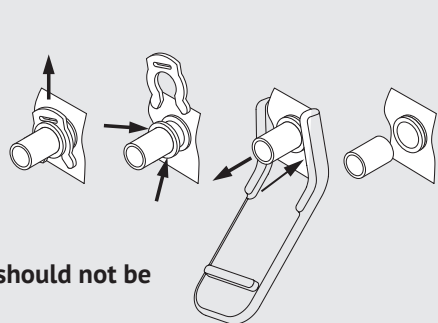

Check that the tube is tight. The tube should not be pulled out with a force of 8–10 kgf.

PRODUCT INSTALLATION

The Drain clamp Installation

It is recommended to install the clamp on the sink drain upstream the S-trap (the drain clamp fits most drain pipes about 40 mm in diameter).

- Attach the part of the clamp with the fitting to the pipe and find the optimal position of the clamp and a hole for the tube.
- Drill a 7 mm hole in the pipe wall in the intended place.
- Remove the cut round part from the gasket (1).
- Remove the protective film (2) from the gasket (1). Attach the gasket (1) on the inside of the clamp so that the hole in the gasket aligns with the hole in the clamp fitting.
- Install the clamp on the pipe, aligning the hole in the fitting with the drilled hole in the pipe, and then tighten the bolts (3). The bolts should be tightened evenly so that the two parts of the clamp are parallel.
- Put the plastic nut on the JG drain tube so that the tube extends from the other side of the nut by at least 20 mm (Fig. 7b).
- Insert the tube into the drain clamp and screw the nut onto the fitting.

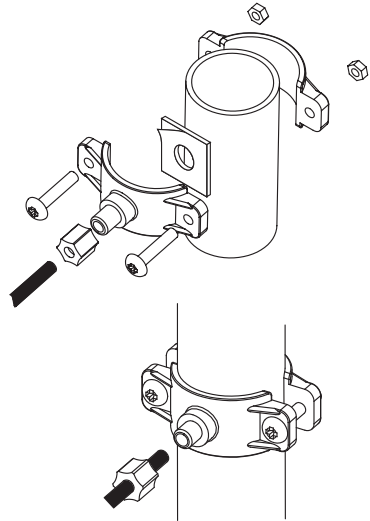

Note. Push the JG tube deeper into the pipe if you are disturbed by the sound of water coming from the drain clamp.

PRODUCT SPECIFICATION

Operational parameters

Power supply	AC 220-240 V ~ 50 Hz
Heater Power Capacity	600 W (10 L/hour)
Chiller Power Capacity	120 W (10 L/hour)
Motor Power Consumption	120 W
Cold Water Temperature	+4...+12 °C
Hot Water Temperature	+70 ...+90 °C
Cold water tank capacity	10.9 L
Hot water tank capacity	3 L
Operating pressure	Min 127 kPa (1.27 bar) Max 294 kPa (2.94 bar)
Chiller type	Compressor
Overall dimensions (width × length × height)	340 x 375 x 1200 mm
Weight	30 kg
Service Condition	Indoor (House/office)

Product Warranty

Product	Dispenser Aquaphor, Model RO PRO 100
Serial Number	
Purchase date	
Customer	
Seller	

Terms of Service and Warranties

Aquaphor products are backed by some of the most comprehensive warranties in the industry. Aquaphor warrants that the Aquaphor water filtration system shall be free from defects in material and workman ship under normal use and service.

Dispenser Aquaphor, Model RO PRO 100 – Two Year Warranty from the date of purchase. This does not apply, however, to consumable filters.

Exclusions and Limitations

1. Aquaphor warrants its products to be free from manufacturing defects under normal use and service. This warranty is extended only to the ORIGINAL PURCHASER.
2. Aquaphor obligations under this warranty are limited to repairs or replacement, at Aquaphor's option, of products or parts found to be defective, provided that such products were properly installed and used in accordance with instructions. Aquaphor reserves the right to make such inspections as may be necessary in order to determine the cause of the defect. Aquaphor will not charge for labor or parts in connection with warranty repairs for the first full year from date of purchase on all products except those that may be subject to commercial use limitations.
3. Aquaphor is not responsible for the cost of removal, return (shipping) and/or reinstallation of products.

This warranty does NOT apply to:

- Damage or loss which occurs during shipment.
 - Damage or loss sustained through any natural or man-made causes beyond the control of Aquaphor, including but not limited to fire, earthquake, floods, etc.
 - Damage or loss resulting from sediments or foreign matter contained in a water system.
 - Damage or loss resulting from negligent or improper installation including installation of a unit in a harsh or hazardous environment.
 - Damage or loss resulting from removal, improper repair, modification of the product, or improper maintenance including damage caused by chlorine or chlorine related products.
 - Damage or loss resulting from acts which are not the fault of Aquaphor or which the Product is not specified to tolerate.
4. This warranty gives you specific legal rights. You may have other rights which vary from state to state.

AQUAPHOR®

Manufacturer: Westaqua-Invest OÜ,
L. Tolstoi 2A, Sillamäe, Estonia, 40231.
www.aquaphor.com